

**WICHITA COUNTY SALES FOR APRIL 7, 2020
SCHEDULED FOR 10:00 A. M.**

Tax Sales Information*

- 1) Tax foreclosure sales are conducted by the Sheriff or a Constable of the county where the property is located. These sales are held on the first Tuesday of the month between the hours of 10:00 a.m. and 4:00 p.m. on the courthouse steps at a place designated by the commissioners' court.
- 2) All sales are without warranty of any kind. **Purchasers receive a Sheriff or Constable's deed that is without warranty.** Bidders should satisfy themselves concerning title and location of the property and improvements on the property including any encroachments *prior* to bidding. **Neither our firm nor our clients can guarantee the title to any property. The tax sale is an "as is", "where is", "buyer beware" sale. If you have any questions about specific liens or ownership of the property, you may research the title yourself or through a title company. The judgments in these cases list the parties included in the tax suit.**
- 3) Taxes may be due beyond what is listed in the minimum bid amounts and must be paid independently of the bid amount.
- 4) For more information regarding the sheriff's sale listed below, please contact Krystle Barboza in the Wichita Falls Office at (940) 723-4323.

Case No.	Legal Description/Address (if available)	Estimated Minimum Bid	Account Number
43,915-B	Lot 5 and southwest 12'X35' Lot 4, Block 52, Floral Heights Addition to the City of Wichita Falls, Wichita County, Texas; 1308 Fillmore St per WCAD	\$1,150.00	149153
43,915-B	Lot 14, Block 21, Jalonic Addition to the City of Wichita Falls, Wichita County, Texas; 1414 14th St per WCAD	\$2,000.00	143034
43,915-B	Lot 8, Block 28, Southland Addition to the City of Wichita Falls, Wichita County, Texas; 1626 Collins Ave per WCAD	\$5,000.00	133460
43,915-B	South one-half Lot 8, Block 45, Southland Addition to the City of Wichita Falls, Wichita County, Texas; 1806 Pearl Ave per WCAD	\$1,800.00	133136
43,915-B	North one-half Lot 8, Block 45, Southland Addition to the City of Wichita Falls, Wichita County, Texas; 1807 Clark St per WCAD	\$1,800.00	133137

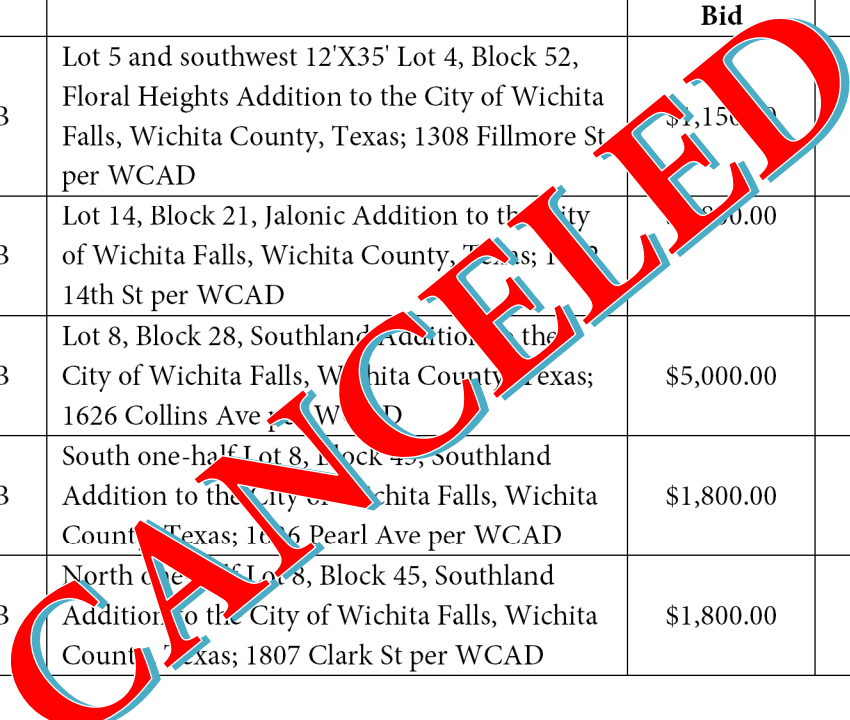

43,915-B	75X150', Abstract 372, E Lewis, to the City of Burkburnett, Wichita County, Texas; 510 Tidal per WCAD	\$4,450.00	118983
44,191-B	Lot 9 and the West 1/2 Lot 8, Block 9, Scotland Addition, to the City of Wichita Falls, Wichita County, Texas; 1217 N 9 th St per WCAD	\$5,000.00	135823
44,142-A	North 40 Feet of South 50 Feet Lot 9 Block 227, Original Townsite Wichita Falls, Wichita County, Texas; 1503 Austin St per WCAD	\$2,700.00	159081
187,293-A	Lot 1 and the North 20 feet of Block 218, Original Townsite Wichita Falls, Wichita County, Texas; 1200 Burnett St per WCAD	\$550.00	159132

This notice and the materials provided herein are for informational purposes only and do not constitute any legal advice. No reader should rely on this notice or refrain from acting on the basis of any information contained in this notice without seeking their own legal or other professional advice. Perdue, Brandon, Fielder, Collins, & Mott, L.L.P. ("PBFCM") DOES NOT WARRANT the quality or completeness of the information provided herein. The information in this notice is not intended to nor does it create any attorney-client relationship between the reader and PBFCM

CANCELLED